

# MONTAGEANLEITUNG

SUN-10172-abc\_BMW X1 2022-



2x A-Teil



2x B-Teil



1x C-Teil



1x \*

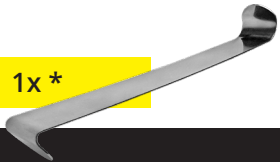

8x SC19.1



4x SC8.20



2x SC9.20

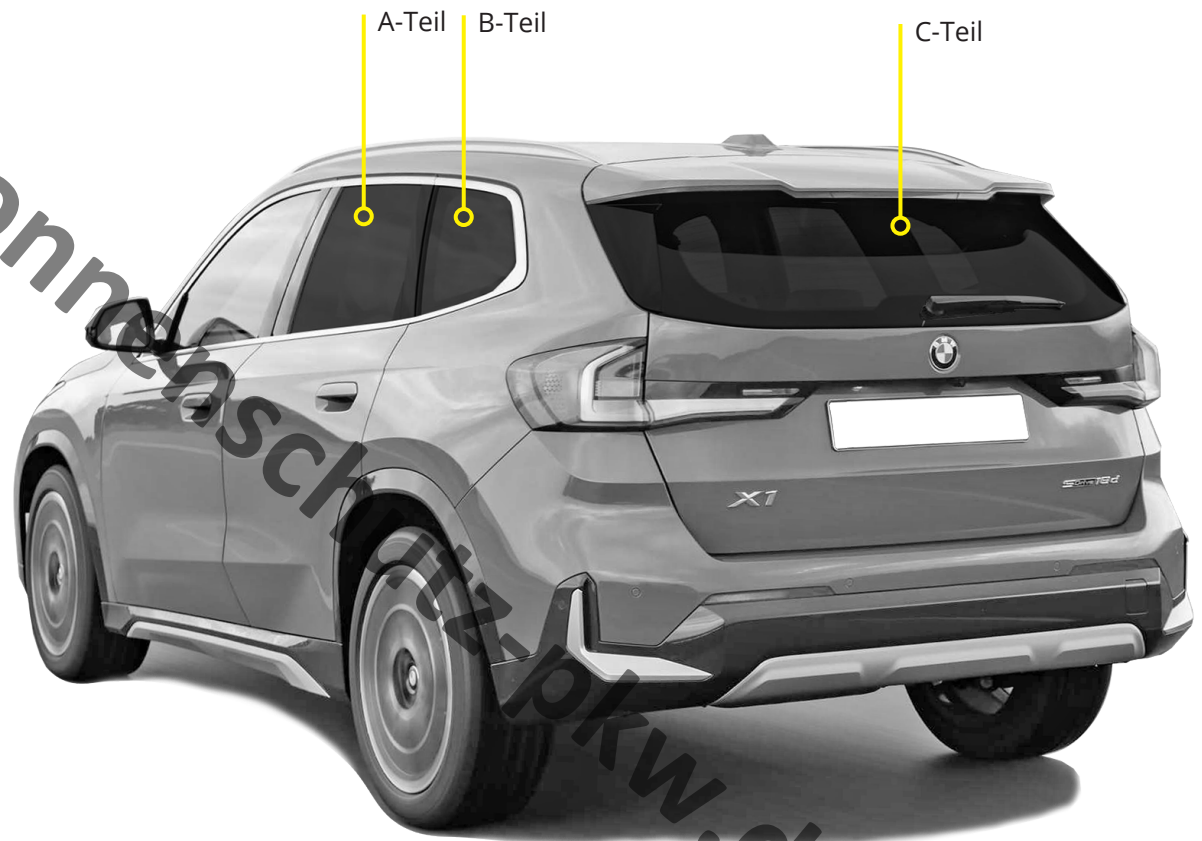

Haben Sie Fragen? Wir helfen Ihnen gerne.

# MONTAGEANLEITUNG

SUN-10172-abc\_BMW X1 2022-

**SONNIBOY**  
UlinAir

2x A-Teil

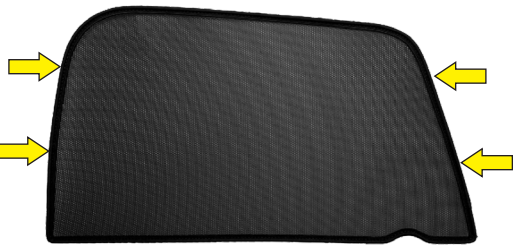

1



2

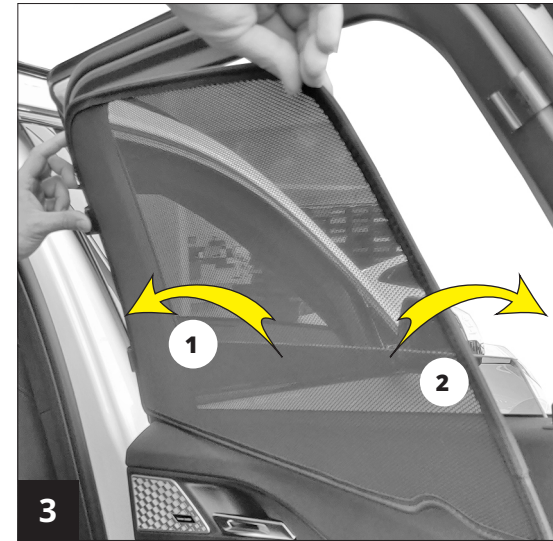

3

4x SC19.1



1x

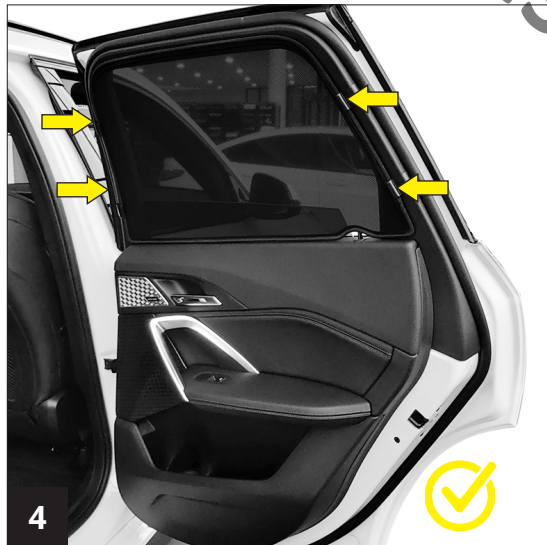
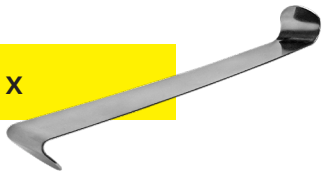

4

(GB) INSTALLATION INSTRUCTIONS  
(ES)STRUCCIONES DE MONTAJE  
(F) INSTRUCTIONS DE MONTAGE  
(I) MANUALE DI INSTALLAZIONE  
(NL) INSTRUCTIES VOOR DE INSRALLATIE  
(DK) INSTALLATIONSVEJLEDNING  
(CZ) POKYNY K INSTALAC  
(PL) INSTRUKCJE MONTAŻU  
(RU) ИНСТРУКЦИИ ПО УСТАНОВКЕ  
(HU) BESZERELÉSI ÚTMUTATÓ

Haben Sie Fragen? Wir helfen Ihnen gerne.

ClimAir PLAVA Kunststoffe GmbH Am Spitzacker 20-22 D-61184 Karben Telefon +49 (0)6039 - 91 63 - 0 Fax +49 (0)6039 - 2185 E-Mail: info@climair.de

# MONTAGEANLEITUNG

SUN-10172-abc\_BMW X1 2022-



2x B-Teil



2x SC8-20

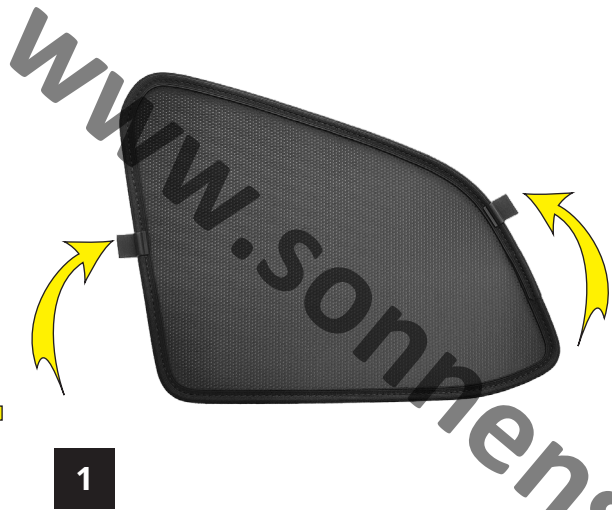

1

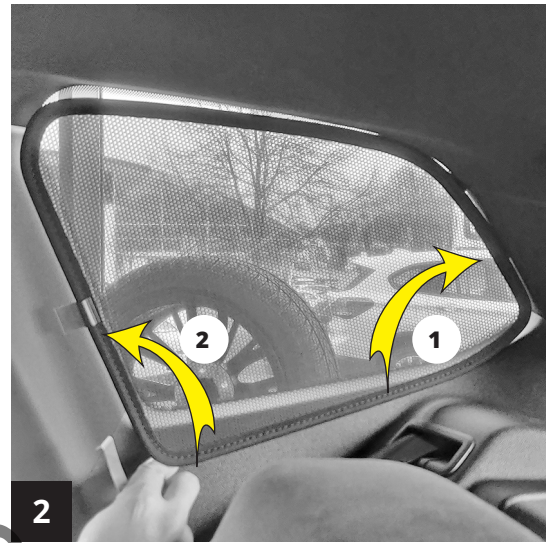

2

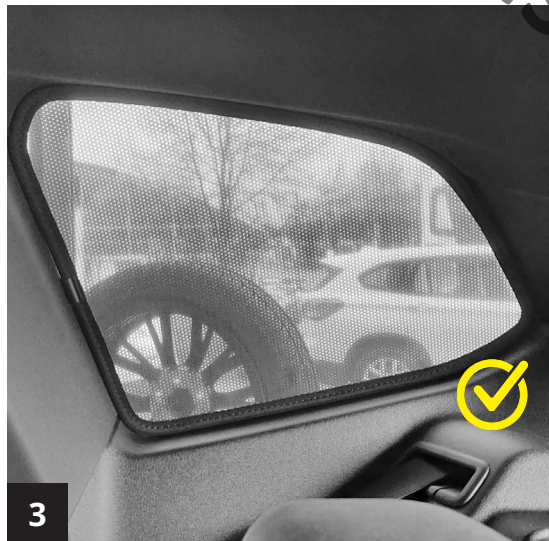

3

(GB) INSTALLATION INSTRUCTIONS  
(ES)STRUCCIONES DE MONTAJE  
(F) INSTRUCTIONS DE MONTAGE  
(I) MANUALE DI INSTALLAZIONE  
(NL) INSTRUCTIES VOOR DE INSRALLATIE  
(DK) INSTALLATIONSVEJLEDNING  
(CZ) POKYNY K INSTALAC  
(PL) INSTRUKCJE MONTAŻU  
(RU) ИНСТРУКЦИИ ПО УСТАНОВКЕ  
(HU) BESZERELÉSI ÚTMUTATÓ



Haben Sie Fragen? Wir helfen Ihnen gerne.

ClimAir PLAVA Kunststoffe GmbH Am Spitzacker 20-22 D-61184 Karben Telefon +49 (0)6039 - 91 63 - 0 Fax +49 (0)6039 - 2185 E-Mail: info@climair.de

# MONTAGEANLEITUNG

SUN-10172-abc\_BMW X1 2022-

**SONNIBOY**  
ClimAir

1x C-Teil



2x SC9-20

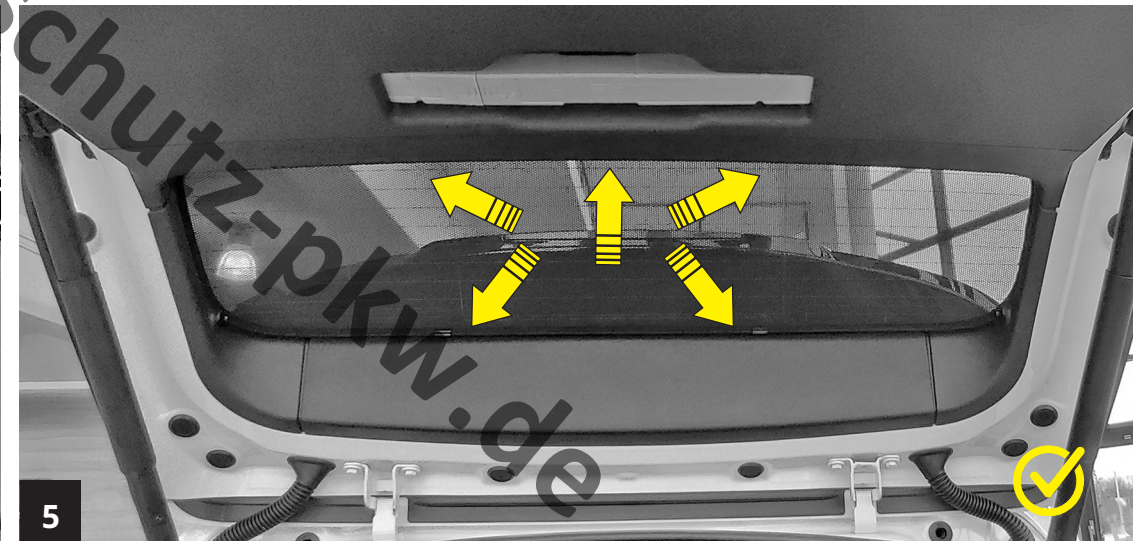
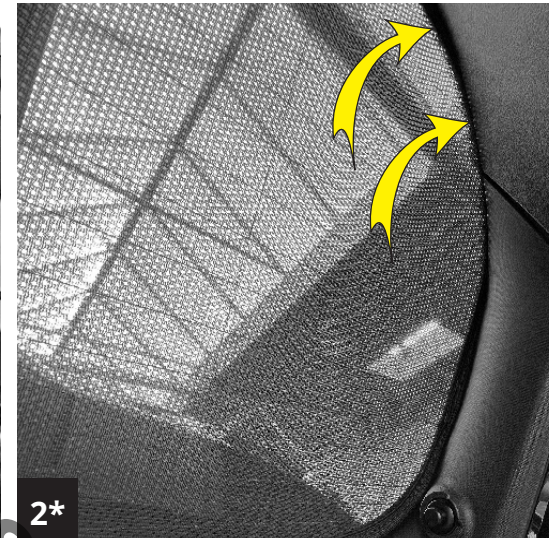
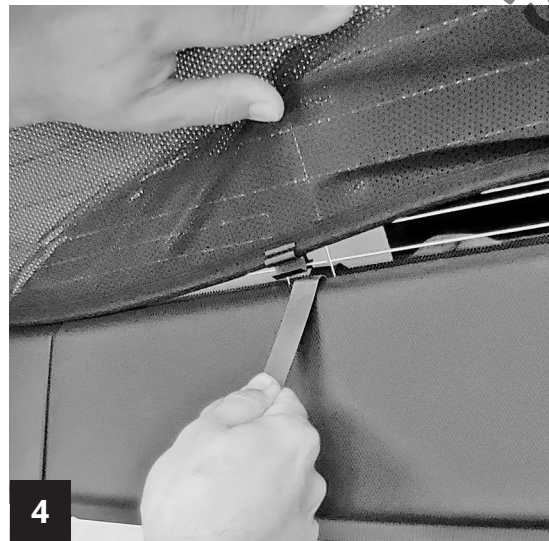
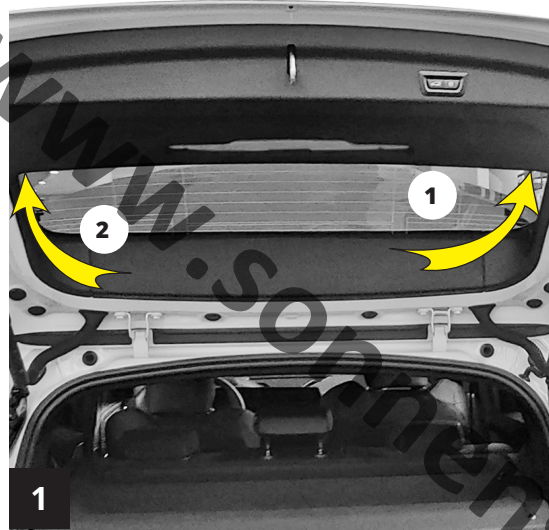

\*Insert between glass and panel for optimal fitment

Haben Sie Fragen? Wir helfen Ihnen gerne.

ClimAir PLAVA Kunststoffe GmbH Am Spitzacker 20-22 D-61184 Karben Telefon +49 (0)6039 - 91 63 - 0 Fax +49 (0)6039 - 2185 E-Mail: info@climair.de